

Eye Nut DIN

Eye Nuts DIN582 are for general use applications, and commonly utilised as a removable lifting where a rated nut can be used.

- Made from C15 carbon steel with zinc plated finish, manufactured with a standard larger eye.
- Conforms to DIN582
- Test certificates are available on request

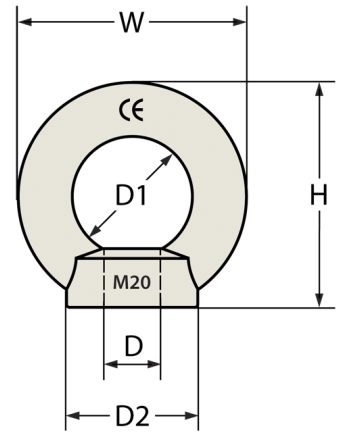

Part No.	Size (mm)	WLL Axial (tonnes)	WLL Side 90 (tonnes)	D (mm)	D1 (mm)	D2 (mm)	H (mm)	W (mm)	Weight (kg)
152001	6	0.09	0.018	6	20	20	36	36	0.055
152002	8	0.14	0.035	8	20	20	36	36	0.06
152003	10	0.23	0.058	10	25	25	45	45	0.1
152004	12	0.34	0.085	12	30	30	53	54	0.19
152005	16	0.7	0.175	16	35	35	62	63	0.31
152006	20	1.2	0.3	20	40	40	71	72	0.45
152007	22	1.5	0.75	22	45	45	80.5	81	0.68
152008	24	1.8	0.45	24	50	50	90	90	0.72
152009	27	2.5	0.625	27	50	50	97	90	1.16
152010	30	3.6	0.9	30	65	65	109	108	1.7
152011	36	5.1	1.275	36	75	75	128	126	2.0
152012	42	7	1.75	42	85	85	147	144	3.0
152013	48	8.6	2.15	48	100	100	168	168	5.1

HEAD OFFICE

A. 4 Christensen Rd, Yatala Q 4207
T. 07 3801 6565
W. stenhouselifting.com.au
E. sales@stenhouselifting.com.au

YATALA 07 3801 6565
MARYBOROUGH 07 4122 1193
WACOL 07 3728 4545

